

# ▶ Ranger Drop Frame ASL

**▶ SIMPLICITY BY DESIGN**

The versatility of manual or automated loading gives the Ranger DF its edge. Designed for the routes that need a rear loader and a side loader all rolled into one truck.

The large enclosed hopper has a loading height of 5-1/2" above the chassis frame providing the lowest possible pitch-in height on the market today. Wind doors are available to enable loading from both sides of the hopper. The standard crusher panel helps to keep trash contained when the loading doors are open.

Bridgeport's Automated Arm adds to the versatility of the Ranger DF with universal grips and the optional 144" extended reach.

**▶ 14" DROP**



**▶ LARGE HOPPER**



**ALL IN ALL  
THE BEST VALUE  
ON THE MARKET TODAY**

**▶ STANDARD FEATURES**

Electric Over Hydraulic Controls

Cab and Outside Control Panels

Automatic Pack Cycle

Crusher Panel

Twelve Month Warranty



**Toll Free: 800.559.8520      500 FM 1658**  
**E-mail: [sales@bridgeportmfg.com](mailto:sales@bridgeportmfg.com)      Bridgeport, TX 76426**

UNIQUE BODY DESIGN



DROP HOPPER

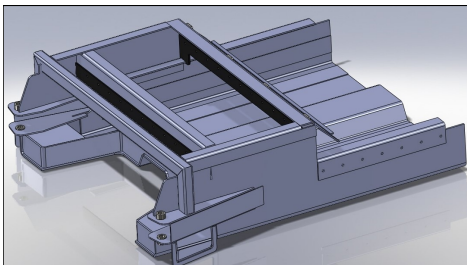

SEMI-AUTOMATED



B R I D G E P O R T M F G I N C

Contact Your Local Dealer:

# Ranger DF Specifications

BODY			
PART	TYPE	SIZE	RESULTS
Standard Specs May Be Modified Per Customer Requirements			
Floor	AR 235	3/16"	70,000 yield strength
Floor Slope - 16° std Optional 21° slope	16° = AR-400 21° = Hardox 450 liner	1/4"	190,000 yield strength
Sides	A-36	3/16"	Cold formed for strength
Roof	A-36	12 ga	Cold formed for strength
Tailgate	A-36 with 3/16" sides	10 ga	80,000 yield strength
Capacity	28 To 38 cu yds		

HOPPER			
PART	TYPE	SIZE	RESULTS
Hopper Wear Strips	Hardox 450	1/4"	190,000 yield strength
Hopper Floor/Sides	Hardox 450	1/4"	190,000 yield strength
Packer / Follower	A-36	3/8"	80,000 yield strength
Packer Frame	Formed A-36	3/8"	80,000 yield strength
Crusher Panel	Formed A-36	1/4"	80,000 yield strength

HYDRAULICS			
PART	BRAND	DESCRIPTION	RESULTS
Packer Cylinder (2)	Texas Hydraulics	4" bore x 42" stroke	More packing force
Hoist Cylinder (2)	Texas Hydraulics	5" bore x 72" 3-stage	42° dump angle
Tailgate Cylinder (2)	Texas Hydraulics	3" bore x 30" stroke	
Piston Pump	Varies	Includes Cartridge Valves	Positive Stop - No Oil Flows Until Controls Are Activated

AUTOMATED ARM		
PART	MODEL	RESULTS
Standard Reach	BMI - SD	96" Reach
Extended Reach Option	BMI - XR	144" Reach

ARM SPECS
Arm is body mounted to relieve chassis of undo stress
Cycle time is 10 seconds at 750 RPM.
Elevator style lift rotates cart to a 45° dump angle with minimum kick-out
Equipped with universal grips to easily lift 30-450 gallon carts
Arm will lift a maximum of 800 lbs approx.